



# **BEENLEIGH FESTIVAL OF ONE-ACT PLAYS**

## **INFORMATION PACK 2021**

**JULY 30,31, AUGUST 1**

***Please read carefully and retain this document for your information.***

## INTRODUCING OUR ADJUDICATOR

### Alan Cooke



ALAN COOKE  
B.A., M.ED., Cert. Teach.

Alan has been involved in theatre performance and production since school days. Since school drama (*Sunday Costs Five Pesos*) to a vast array of one act, full-length plays and large-scale musicals, his hobby has been theatre. For the past 50, or more, years, he has worked on and off stage in many facets of performance with the exception (by choice) of anything electrical.

With a special love of farce and comedy, Alan still finds a challenge with many other genres in the non-musical arena. He has competed in drama festival competitions in Wide Bay, the south-east corner and Townsville winning a number of awards for Best Director, Best Play,

Best Actor and Best ensemble as well as several community awards for contribution to performing arts in the Townsville district.

By far, performance is his favourite but, in recent times, direction has taken precedence as he has a yen to see younger performers develop their repertoires. The most memorable among his performances include George in *Who's Afraid of Virginia Woolf?*; Henry Higgins in *My Fair Lady* and , last year the title role in *The Father* by Florian Zeller.

Alan adjudicated the 2020 online writing and monologue festival which BTG created in response to COVID, and is sincerely looking forward to seeing some of those works and actors in the flesh this year.

# CONDITIONS OF ENTRY

*Please read carefully, we review conditions annually, there are some **IMPORTANT POINTS** in our Conditions of Entry.*

Each entry must be ON THE OFFICIAL ENTRY FORM (available on our website), accompanied by

Entry Fee appropriate to section entered  
THREE original scripts (please mark **ALL ALTERATIONS** and lighting/audio cues)  
Official Entry Form (completed in full)  
A photo or artwork if possible (suitable for social media promotion)  
Stage and lighting plans **completed in full**  
Performing Rights consent

**ALL ENTRY MATERIAL MUST BE RECEIVED BY THE FESTIVAL COORDINATOR by close of business 20 JUNE 2021.**

1. The One Act Play Festival Committee of Beenleigh Theatre Group reserves the right to
  - a. decline any entry.
2. Should it be necessary to limit the number of entries, the first entry of any theatre
  - a. company will be given preference over second entries from the same company.
  - b. Groups entering more than one play are therefore asked to nominate in order of
  - c. priority for this purpose.
3. Entry fees to Beenleigh Festival of One-Act Plays are non-refundable.
4. Age group limitations are as follows: Youth – 18 years and under
  1. Open – 19 years and over.
5. Age is defined as **AT THE DATE OF THE START OF FESTIVAL**
  - a. ie. 30 JULY 2021
6. Each play in the Open and Youth sections of the festival will be no less than 20 minutes and **NO MORE** than 45 minutes duration. Plays in the Ten Minute Section will be no less than 9 minutes and no more than 11 minutes.
7. Ten Minute Play Section: should more than five entries be received, this competition will be run and adjudicated in the first session of the festival **ONLY**. There is no separate Youth section for Ten Minute Plays.
8. 'Original' scripts are those that have not been staged prior to 2021.
9. Youth Plays must be made up of cast members up to and including 18 years of age but not over. [see rule 6 above] If one cast member is aged 19 the entry is deemed to be Open.

10. It is the responsibility of each group to obtain permission in advance from the Author's Agent to present the play and to pay any royalties involved. Failure to do so will result in disqualification. BTG Inc takes no responsibility for plays performed without performing rights.
11. The Festival Stage Manager will be in complete charge of the stage and back stage areas during the Festival.
12. The arrangement of the stage setting will be the responsibility of each group. There will be an allowance of TEN MINUTES for setting of the stage and FIVE MINUTES for striking, except in the case of the Ten Minute Section where there will be an allowance of FIVE MINUTES for setting and FIVE MINUTES for striking.
13. Each group will provide its own Stage Manager, who will be responsible for the setting and striking of that group's set and control of the stage crew during the performance and striking of the set.
14. **Special WPHS requirement re use of certain elements on stage.**
  - a. The use of any of the following **MUST BE APPROVED FOR USE** prior to the commencement of the festival. Complete the relevant section on the entry form if any of the following occur in your performance.
    - Strobe Lighting
    - Smoke
    - Naked Flames
    - Water
    - Breaking of Glass
  - b. Failure to comply will result in **AUTOMATIC DISQUALIFICATION OF THE ENTRY**. No further discussion will be entered into.
15. **NO UNOFFICIAL PHOTOGRAPHY** is permitted during any performance and all mobile phones **MUST BE SWITCHED OFF** within the stage, wings and auditorium areas.
16. Each group will provide a Lighting and Sound Effects Advisor, who will be responsible for the technical direction of the production. At all times, a Beenleigh Theatre Group Technician will be in charge of the equipment. Changes cannot be made to the lighting rig which will be standard throughout the festival.
17. Each group will provide its own props, furniture and such other accessories as it needs. Beenleigh Theatre Group will enable easy access to Stage Doors and Props area.
18. No full rehearsals will be allowed on the stage prior to the allocated walk through session on the day of performance.
19. A BTG host will be assigned to each group for the session of their performance. They will meet entrants, provide competitors tickets, running orders and facilitate dressing room and tech organisation and location.
20. **THIRTY MINUTES** prior to each session the loading dock will be **CLOSED**. It is not possible for the roller door to be opened once a session has commenced. **Regardless of where your play is in the running order you MUST have all large set pieces loaded BEFORE commencement of the FIRST play of the session.**

21. The Adjudicator will give brief comments at the end of each session on the plays performed in that session.
22. During a performance only cast and crew members of that production are allowed on the stage or in the back stage areas.
23. Should any section have less than FIVE entrants no third prize will be awarded to that section. If there are less than THREE entries in any one section no monetary prize will be awarded, unless at the discretion of the Festival Committee.
24. If in the event of an inability to attend ON TIME as per scheduled **the Co-ordinator must be notified by phoning the theatre on 3807 3922, the Festival Coordinator on 0416270883 or the Stage Manager on 0422805327 as early as possible.** This assists the organisers to avoid unnecessary delays.
25. The Adjudicator will assess each play on the following criteria, this will be done using a points system. All entrants will be given feedback as part of their written adjudication.
  - i. Choice of Play
  - ii. Character creation and performance
  - iii. Stagecraft [sets, lighting, costumes, make-up, use of stage space]
  - iv. Direction
  - v. Audience Impact
26. The decision of the Adjudicator is final and absolute, and no correspondence will be entered into.
27. All groups will have the opportunity to WALK the stage for a 10 minute ONLY stage familiarisation which will be scheduled in the hour before the commencement of the SESSION. No extension to this is possible, and the Stage Manager's direction must be followed. **During this time, no props or sets may be brought onto the stage unless at the Stage Manager's discretion.** However the Lighting and Sound Technicians will be available for light and sound level checks.
28. ALL participants in the festival i.e. Cast, Director, Stage Manager and up to TWO crew members will be admitted FREE to the session in which they are scheduled to perform.
29. **NORMAL** admission is payable to **ALL** other sessions by all entrants and supporters.

Admission Prices: SINGLE TICKETS PER SESSION *available from box office during Festival ONLY:*

ADULTS	\$15.00 (inc gst)
CONCESSIONS [under 18/Pensioners]	\$10.00 (inc gst)
FESTIVAL PASS(multiple sessions)	\$25.00 (in gst)

**Normal admission prices per session are payable by all non-cast members who wish to view the performance.**

## **SPECIAL CONDITIONS APPLICABLE TO PERPETUAL TROPHIES**

<b>Winners Trophies will accompany all Perpetual Shields</b>
--

### **‘THE GREGORY SHIELD’**

Our founders Margaret and Dan Gregory instigated this award in 2002 in special recognition of the impact and opportunity theatre provides for young people.

The award will be at the adjudicator’s discretion and will be granted

- **To a person 18 years or under who shows excellent potential .**

- An individual recipient can be a member of any section of the festival, Youth or Open

***BUT if it is awarded to a ‘play’ as a group under 18 it must be chosen from the Youth section.***

Plays in the Open section are **NOT ELIGIBLE** for this award.

### **“THE REDHEAD SHIELD’**

A perpetual shield donated by the family of Derek and Stella Redhead, in recognition of the life-long contribution their parents have made to live theatre in the Beenleigh District.

At Adjudicator’s discretion, this shield is awarded to the **BEST DIRECTOR** of the entire Festival, irrespective of section.

### **‘BEST ORIGINAL WORK’ SHIELD**

This perpetual award is granted to the **PLAYWRIGHT** whose play is judged by the adjudicator to be the ‘**Best Original Work**’ of the festival . \**SEE RULE 8*

### **‘THE JOY CORBY MEMORIAL SHIELD’**

In Memory of Joy Corby, a very loyal and passionate member of BTG, whose contribution was always marked by her outstanding attention to detail of design. Awarded to **Best Design of the Festival**. Kindly donated by her family.

### **‘LIONS CLUB TROPHY’**

Awarded to the **BEST AUSTRALIAN PLAY** of the Festival.

### **‘SOROPTIMIST INT. BEENLEIGH Inc. SHIELD’**

Awarded to the **BEST FEMALE ACTOR** of the festival.

### **‘WESTPAC BANK, BEENLEIGH SHIELD’**

Awarded to **BEST MALE ACTOR** of the festival.

### **‘SHARON SOWARD SHIELD’**

Awarded to the **BEST FEMALE IN A COMEDIC ROLE** in the whole festival.

### **‘MAYOR’S SHIELD’**

Awarded to the **BEST PLAY in the OPEN** section.

<b>Note: All Perpetual shields to be retained by Beenleigh Theatre Group</b>
--

## **CASH PRIZES (SPECIAL CONDITIONS)**

### **‘DOYENNE’**

Awarded to a mature female actor in the Open section, whose significant theatrical experience makes a minor role a memorable one. Not to be awarded to a recipient of the ‘Best Supporting Actor Female Open’ or ‘Best Female Actor Open’.

### **‘BRIOHNE SYKES MOMENT OF TRUTH’**

Awarded to an actor, writer, director or ensemble for creating a powerful dramatic moment that confronts the audience with a truth or change in perspective which has a significant effect on them. Created by Briohne Sykes, an active BTG member who loved writing and performing, as an encouragement for playwrights and performers to confront audiences with difficult topics.

## **AWARDS FOR THE 2021 FESTIVAL**

**OPEN SECTION:**

- Best Play + \$100.00
- 2<sup>nd</sup> Best Play + \$50.00
- 3<sup>rd</sup> Best Play
- Best Director
- Best Actor Male in a Dramatic Role
- Best Actor Female in a Dramatic Role
- Best Actor Male in a Comedic Role
- Best Actor Female in a Comedic Role
- Best Supporting Actor Male
- Best Supporting Actor Female
- ‘Doyenne’ cash prize \$100
- Adjudicator’s Awards

**YOUTH SECTION:**

- Best Play + \$100.00
- 2<sup>nd</sup> Best Play + \$50.00
- 3<sup>rd</sup> Best Play
- Best Director
- Best Actor Male
- Best Actor Female
- Best Supporting Actor Male
- Best Supporting Actor Female
- Adjudicator’s Awards

**TEN MINUTE SECTION**

- Best Play
- Best Performer in a Ten Minute Play

**GENERAL:**

- Best Backstage Management
- Briohne Sykes Moment of Truth cash prize \$100

STAGING PLAN

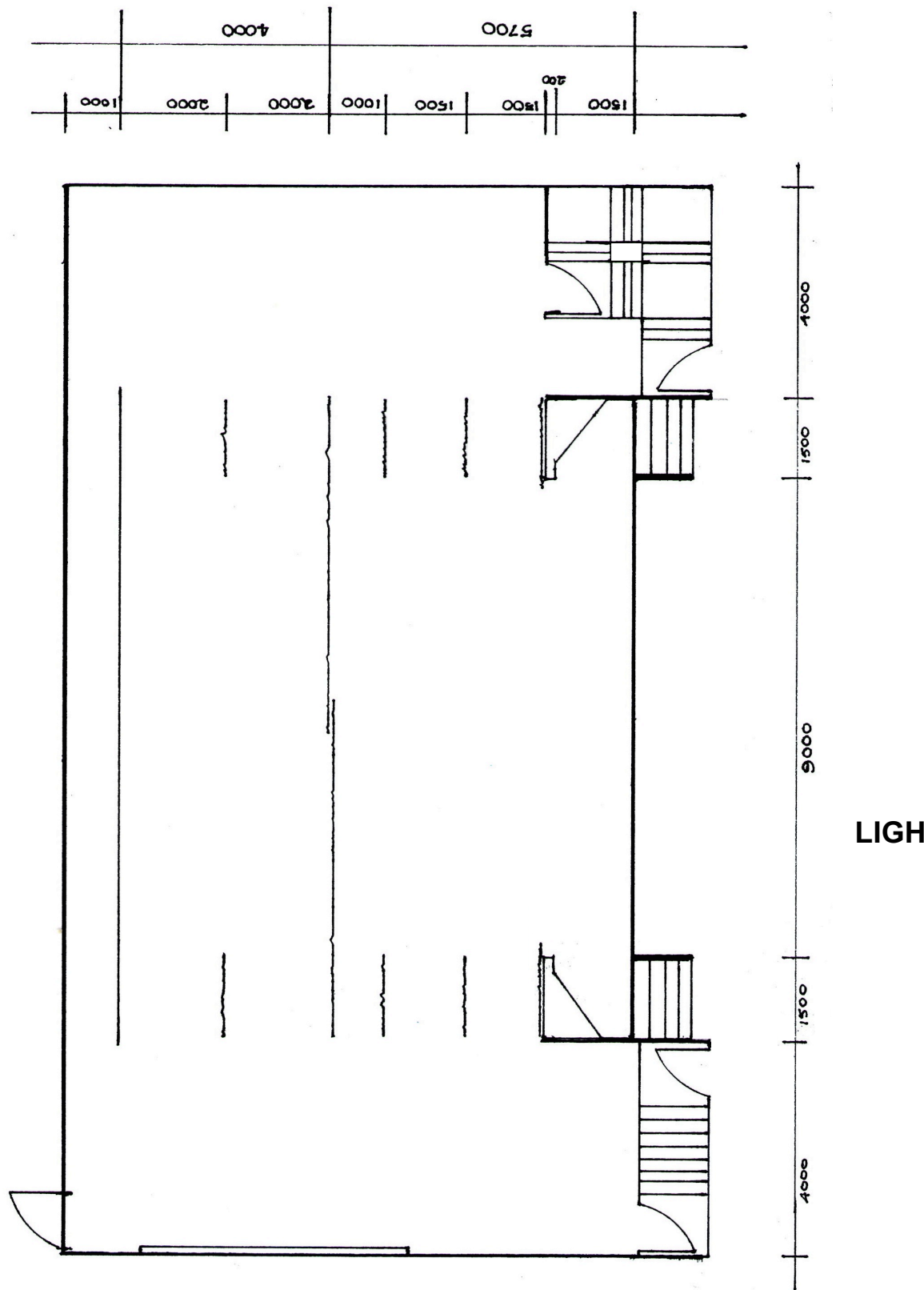



# **'LIGHTING PLAN**

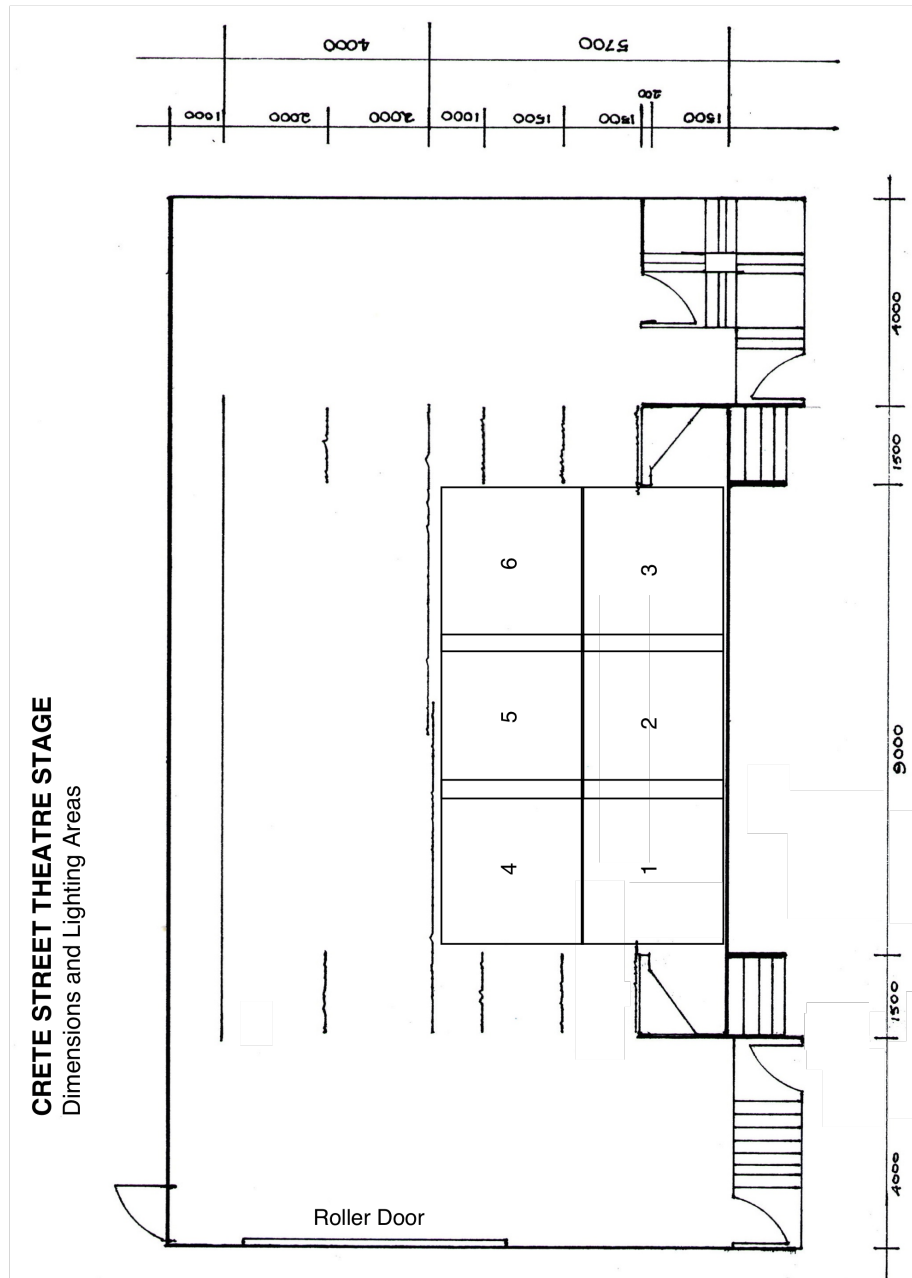

# Technical Specifications

## LIGHTING

The stage will be split into six (6) sections. Three (3) across and two (2) deep. Each section will be lit by four (4) lamps with additional coloured fixtures. (See diagram above)

### PER SECTION-

#### FRONT LIGHT

2 x 1K Profiles (warm wash)

1 x 1K fresnel (cool wash)

RGB LED wash (Coloured wash - front sections only)

#### OVERHEAD LIGHT

1 x 1K Fresnel

1 x LED RGB ParCan

The overhead LED fixtures may be used for colour wash (RGB). The Front LED's are used for colour wash (RGB) and spread across the whole front of stage. These are in 4 sections.

## SOUND

The Crete Street Theatre is set up with a full sound system. Festival setup will allow SFX or incidental music to be played via CD player or laptop. Handheld devices can be connected to the system.

A wired handheld microphone will be available at stage level if required.

## ACCESS

Props and set should be loaded onto the stage via roller door on OP side of stage, accessed via the driveway from Kent St, adjacent to the Beenleigh State School. This door will be CLOSED thirty minutes before the beginning of each session.